

1- K57V Transmission

K57V Seal Kit

Kit Includes

#17	#91
#19	#92
#20	#94
#30	#99
#59	#104
#72	#105
#81	#106

All parts may not be used.

K57V Repair Kit

Kit Includes

#24	#38
#31	
#200-Seal Kit	

All parts may not be used.

201

200

Utgåva Issue		Bildnr Picture No		KANZAKI TRANSAXEL K57V (s/n 0000001- 9999999)		KANZAKI TRANSAXLE K57V (s/n 0000001- 9999999)		Sida Page	
2011- 11		2824						452	
Pos. Fig.	Antal/Quantity				Art nr Part No	Benämning	Description	Sats Kit	Anmärkning Notes
	57V								
X	1	1			1137-0126-01	Transaxel kpl.....	Transaxle assy.....		Kanzaki K57V Inkl. pos 74
	2	1			1139-1470-01	Hus- övre	Housing- upper		
X	3	1			1139-1728-01	Hus- nedre	Housing- lower		Inkl. pos 17
	5	1			1139-1301-01	Rör	Tube		
	6	2			1139-1336-01	Slangklämma.....	Hose clamp		
	7	1			1139-1306-01	Adapter.....	Adapter		
	8	2			1139-1150-01	Magnet	Magnet		
	9	1			1139-1341-01	Hållare- magnet	Holder- magnet		
	11	1			1139-1347-01	Fjäder.....	Spring		
	12	1			1139-1251-01	Axel- bypass	Shaft- bypass		
	13	1			1139-1189-01	Arm- bypass	Lever- bypass.....		
	14	1			1139-1161-01	Låsring	Ring		
	15	1			1139-1275-01	Plugg.....	Bore plug		
	16	1			1139-1104-01	Låsring	Snap ring		
	17	2			1139-1103-01	• Tätningbricka	• Seal washer.....	S	
	18	2			1139-1500-01	Dräneringsskruv	Drain bolt kit		
	19	2			1139-1117-01	• O- ring	• O- ring	S	
	20	1			1139-1119-01	• Tätning	• Seal	S	
	21	4			1139-1455-01	Skruv.....	Tapping screw		
	22	12			1139-0244-01	Skruv.....	Tapping screw		
X	24	1			1139-1731-01	Centrumhus.....	Center case	R	
X	25	1			1139-1158-01	Stift.....	Pin		
	27	2			1139-1718-01	Bult.....	Bolt		
	28	2			1139-1468-01	Ventil	IDS valve.....		
	29	2			1139-1243-01	Fjäder.....	Spring		
	30	2			1139-1307-01	• Filter	• Filter	S	
	31	1			1139-1356-01	• Cylinderblock kpl	• Cylinder block assy	R	
	32	1			1139-1245-01	Fjäder.....	Spring		
	34	3			1139-1146-01	Låsring	Ring		
	35	1			1139-1110-01	Kullager	Ball bearing		
	36	1			1139-1458-01	Hus.....	Housing		
	37	1			1139-1438-01	Lager.....	Bearing.....		
	38	1			1139-1509-01	Cylinderblock kpl	Cylinder block kit	R	
	39	1			1139-1160-01	Bricka	Washer.....		
	40	1			1139-1353-01	Motoraxel	Motor shaft		
	41	1			1139-1021-01	Låsring	Snap ring		
	42	1			1139-1272-01	Motordrev.....	Motor gear		
	43	1			1139-1453-01	Lager.....	Bearing.....		
	44	2			1139-1066-01	Tryckplatta.....	Metal thrust.....		
	45	1			1139-1597-01	Stänkplatta.....	Swash plate.....		
	46	1			1139-1508-01	Lager.....	Thrust bearing kit.....		
X	47	1			1139-1729-01	Innerrotor	Inner rotor.....		
	48	1			1139-1151-01	Yttre rotor.....	Outer rotor		
	49	1			1139-1354-01	Regleraxel.....	Control shaft		
	50	1			1139-1410-01	Excenter.....	Fulcrum.....		
	51	1			1139-1312-01	Fjäder.....	Spring		
	52	1			1139-1409-01	Reglerarm.....	Control arm.....		
	53	1			1139-1325-01	Reglerarm.....	Control lever		
	54	1			1139-1596-01	Ryckplatta.....	Jerky plate.....		
	55	1			1139-1102-01	Bricka	Washer.....		
	56	1			1139-1355-01	Saxpinne.....	Cotter pin		
	57	1			1139-1329-01	Stift.....	Pin		
	58	1			1139-1285-01	Stift.....	Pin		
	59	2			1139-1115-01	• O- ring.....	• O- ring	S	
	60	1			1139-1127-01	Mutter.....	Nut		
	61	1			1139-1404-01	Differentialdrev kpl	Differential gear kit.....		
	62	1			1139-1258-01	Slutdrev	Final gear		
	63	1			1139-1255-01	Hylsa	Collar		
	64	1			1139-1256-01	Reduktionsaxel	Reduction shaft.....		
	65	2			1139-1398-01	Bricka	Washer.....		
	66	1			1139-1267-01	Reduktionsdrev	Reduction gear		
	67	1			1139-1361-01	Slutdrev	Final pinion		
	68	1			1139-1344-01	Hjulaxel- vä	Axle shaft- left		

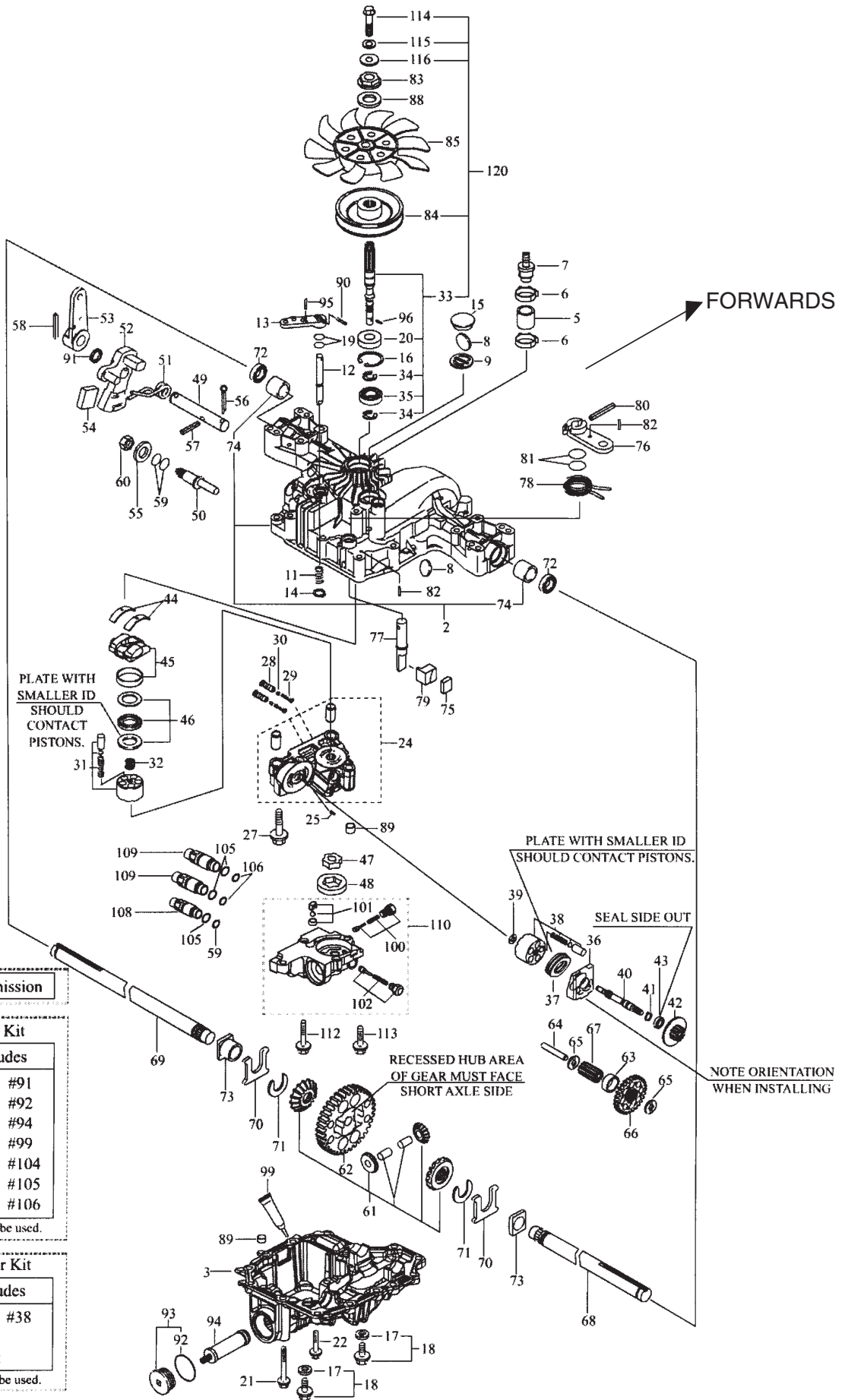

1- K57V Transmission

K57V Seal Kit

Kit Includes

#17	#91
#19	#92
#20	#94
#30	#99
#59	#104
#72	#105
#81	#106

All parts may not be used.

K57V Repair Kit

Kit Includes

#24	#38
#31	
#200-Seal Kit	

All parts may not be used.

200

201

Utgåva Issue		Bildnr Picture No		KANZAKI TRANSAXEL K57V (s/n 0000001-9999999)		KANZAKI TRANSAXLE K57V (s/n 0000001-9999999)		Sida Page	
2011-11		2824						454	
Pos. Fig.	Antal/Quantity				Art nr Part No	Benämning	Description	Sats Kit	Anmärkning Notes
	57V								
69	1			1139-1345-01	Hjulaxel- hö	Axle shaft- right			
70	2			1139-1078-01	Tryckbricka	Thrust washer			
71	2			1139-1163-01	Låsring	Ring			
72	2			1139-1080-01	• Tätning	• Seal	S		
73	2			1139-1164-01	Bussning	Bushing			
74	2			1139-1414-01	• Bussning	• Bushing			
75	1			1139-1260-01	Bromssko	Brake shoe			
76	1			1139-1261-01	Bromsarm	Brake arm			
77	1			1139-1320-01	Bromsaxel	Brake shaft			
78	1			1139-1411-01	Returfjäder	Return spring			
79	1			1139-1264-01	Bromstryckare	Brake actuator			
80	1			1139-1282-01	Stift	Pin			
81	2			1139-1114-01	• O-ring	• O-ring	S		
82	2			1139-1281-01	Stift	Pin			
83	2			1139-1248-01	Krage	Spline collar			
84	1			1139-1469-01	Remskiva	Pulley			
85	1			1134-4190-01	Fläkt	Fan			
88	1			1139-1276-01	Bricka	Collar			
89	4			1139-1166-01	Tapp	Pin			
90	1			1139-1280-01	Stift	Pin			
91	1			1139-1303-01	• Tätningsring	• Oil seal	S		
92	1			1139-1534-01	• O-ring	• O-ring	S		
93	1			1139-1510-01	Lock	Cap kit			Inkl. pos 92
94	1			1139-1186-01	• Filter	• Filter	S		
95	1			1139-1279-01	Stift	Pin			
96	1			1139-1148-01	Stift	Pin			
99	1			1139-1443-01	• Tätningsmedel	• Sealant	S		
100	1			1139-1462-01	• Ventil	• Valve			
101	1			1139-1234-01	• Ventil kpl	• Check assy			
102	1			1139-1463-01	• Ventil	• Valve			
105	3			1139-0239-01	• Packning	• Packing	S		
106	2			1139-1168-01	• Packning	• Packing	S		
108	1			1139-1460-01	Nippel	Piping			
109	2			1139-1464-01	Anslutning	Connector			
X 110	1			1139-1730-01	Pumphus kpl	Pump case assy			Inkl. pos 100 - 102
112	1			1139-1473-01	Bult	Bolt			
113	1			1139-1471-01	Bult	Bolt			
X 114	1			1139-1719-01	• Bult	• Bolt			
X 115	1			1139-1720-01	• Låsbricka	• Lock washer			
X 116	1			1139-1721-01	• Bricka	• Washer			
X 120	1			1139-1725-01	Pumpaxel kpl	Pump shaft kit			Inkl. pos 33,114-116
200	1			1139-1481-01	Servicesats	Seal kit	R		Märkta S/Marked S
X 201	1			1139-1732-01	Reparationssats	Repair kit			Märkta R/Marked R